

# Determining Your Existing Toilet's Flush Volume

You must replace a working toilet flushing 3.5 gallons per flush or higher to qualify for a rebate.

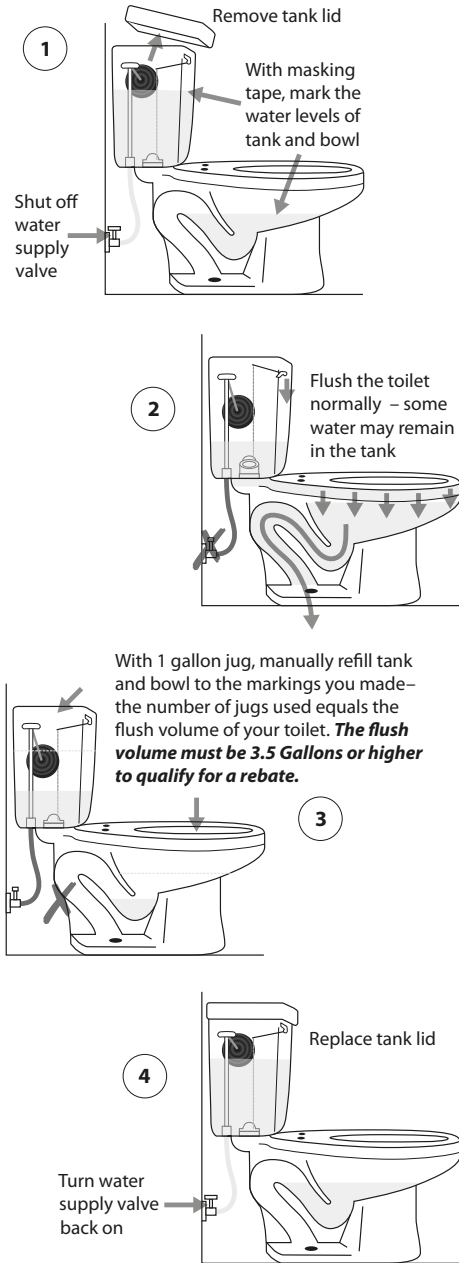

# Selecting a Model

We recommend that you consult with a licensed plumber to select and install your toilets.

It is the responsibility of the applicant to determine the suitability of the site for installation of High-Efficiency Toilets.

### VERY IMPORTANT:

*Manufacturers' toilet model numbers can be confusing. In order to qualify for a rebate, the HET you purchase must match EXACTLY to the model numbers on the List of Qualifying Toilets.*

### EXAMPLES:

TOTO CST744E

KOHLER K-3496-HE

TOTO CST744S

KOHLER K-3496

# Basic Types Of HETs

A pressure-assist toilet has a sealed vessel inside the tank that contains air, which becomes pressurized when water from the supply line fills the vessel. When the flush button is pressed, the pressurized air exerts force on the water in the vessel and the water shoots into the bowl, creating a very fast flush that has a "whooshing" sound.

The noise level of a pressure-assist toilet is slightly greater than standard gravity-flush toilets. However, the result is a reliable flush.

Some HETs are also dual-flush, which allows you to select the amount of water that is used to flush the toilet. There are different style buttons and levers that control the toilet flush volume, as seen in the examples to the right.

